



Features

- ~ Recording through the Line-in is directly stored to USB or SD Card.
- ~ Offers USB and SD Card function of each replication.
- ~ Adjustable recording quality, choice of 128Kbps and 192Kbps.
- ~ Accepts 128MB to 16G USB or SDHC Cards
- ~ Playing format: MP3, WMA
- ~ Recording format : MP3

Recording

Insert USB Thumb drive or SD card into appropriate slot. USB or SD will appear on LCD display.

Recording quality adjustment: Press and hold **FOLDER** button more than 3 seconds to choose the recording quality. Press **REV** or **F. WD** button to select 128Kbps or 192Kbps. Press **FOLDER** again to confirm.

Select folder Press **FOLDER** button, LCD screen will display **F**. Press **REV** or **F. WD** button and then press a number 0 to 9 button to select the directory .

When USB and SD Card are both in the device :

Press the **REC** (START / STAND BY) button. LCD display will start flashing to indicate which device you will be recording to.

Press **USB / SD** button to select the option to record to USB or SD card.

Press **REC**, LCD shows "wait REC". Waiting for USB or SD Card to reach ready mode. When LCD shows "**Stand By**", press "**REC**" again to start the recording, **REC** will flash on LCD display indicating that you are recording. Press **STOP** button to stop recording. LCD shows the recording time of the track.

When only single USB or SD Card in the device:

Press **REC** (START / STAND BY), LCD shows "wait REC". Waiting for USB or SD Card to reach ready mode. When LCD shows "**Stand By**", press "**REC**" again to start recording. **REC** will **flash** on LCD display indicating that it is recording. LCD shows the recording time of the track.

Playback:

To Play **REC** track in folder: press **FOLDER** button, LCD displays "**F**". Use **REV** or **F. WD** button to select the directory **REC**, press **PLAY / II** to start playing. The track number in the **REC** Folder will start from "REC 001". To check the recording file, the song will be recorded after the last track in the **REC** folder.

COPY

Copy Function Button: for USB Copy to SD or SD Copy to USB. Press **STOP** key, insert USB and SD Card, use **USB / SD** button to select the device you want to copy the source of any of the following options;

Copy single: Press **REV** , **F. WD** button or 0 ~9 Numeral keys to select tracks then press **COPY** button to start copying

Copy the multi-tracks or multi-directories:

Select the tracks and store the tracks in the Program Memory first (please refer to Program Memory Function).

Press **COPY** button to copy the tracks stored in the Program, if you are copying to SD, LCD display will flash **SD** and indicates that it is recording to the SD card.

Copy the whole Folder:

Press **FOLDER** button, when LCD displays "**F**", use **REV** or **F.WD** button to select the folder you want to copy. Press **COPY** key to start to copy the selected directory. If you are copying to SD, **SD** will **flash** on LCD display indicating that it is recording to the SD card. Or **USB flashing** for USB card.

The tracks recorded through **COPY** function are stored in the folder "**CPY**" To play folder "**CPY**" of the tracks, press **FOLDER** button, LCD display "**F**" then press **REV** or **F. WD** button to select the directory **CPY** and press **PLAY / II** to start playing.

Copy Tracks without Folder:

If you want to copy 5 tracks each from 3 folders (total 15 tracks) they will be copied as CPY001 ~ CPY015 in the **CPY** folder after copying. If you copy a new track later, it will be shown as CPY016.

A→B: Section Repeat Play

Press once to start playing the beginning of memory.
Press again to stop at the end of memory area.
The device repeats all tracks in memory area.
Press it again to stop playing.

USB / SD Playing

Function Buttons:

PLAY / II: Play and pause, press to play, press again to pause.

STOP: Press to stop playing

USB / SD: Select to use USB or SD CARD

REPEAT / PROG: Press to select Repeat or Program Memory Function

REV: Press to go back to last track. Press for 3 seconds to fast reverse the track.

F. WD: Press to fast forward to next track. Press for 3 seconds to fast forward the track

IR Sensor: Infrared remote control eye.

DEL: Delete single / folder - all of the files.

Repeat function : Need to operate in the playing mode

Press once, LCD screen displays "**REP**", will repeatedly play back current track.

Press twice, LCD screen displays "**REP F**", will repeat the entire folder currently being played.

Press 3rd times, LCD screen displays "**REP ALL**", will replay all tracks.

Press 4th times, cancel repeat playback function. The words on LCD screen will be eliminated.

Program Memory function: Need to operate in the stop-play mode, can program up to 99 songs

Single or multi-tracks memory:

Press the **STOP** button to stop playback.

Press **PROG / REPEAT** button, LCD screen displays **PROGRAM**. Select desired songs by using number keys 0 to 9, or **REV** or **F. WD** key.

Press **PROG / REPEAT** button to store 1st song, LCD display shows "00 01" for the 1st song. Press **PROG / REPEAT** again and **REV** key or **F. WD** button for storing 2nd song; LCD display shows "00 02". Start above process over again for storing more songs.

Press **PLAY / II** memory to play the tracks stored in the Program.

Whole folder memory:

Press the **STOP** function key to stop playback

Press **PROG / REPEAT** button, LCD screen display shows **PROG**, press the **FOLDER** button with the number of combination of keys or **REV / F. WD** button to select the folder.

Press **PROG** to store selected folder. To store more folders, repeat above steps.

Press **PLAY / II** button to start playing memorized folders.

To memorize multi-folders or multiple tracks, repeat above steps, LCD will show **FULL** when you have stored 99 songs.

To cancel program feature, keep pressing **PROG** button until LCD display **PROG** disappears.

Deleting Folders / Files:

Delete current playing track, can be operated under "Stop" mode or during "Playing" mode

Press **DEL** button, LCD displays flash **DEL FILE**, press **DEL** button again to confirm the deletion, LCD display shows **DEL END**.

Delete a folder:

Press **FOLDER** button to select the folder you want to delete, Press the **DEL** button, LCD display flashes **DEL FOLDER**, press **DEL** again to confirm the deletion, LCD displays **DEL END**, the folder is removed.

Delete all the files:

In the stop-play mode operation press the **STOP** button. Press **DEL** key for more than 5 seconds. LCD display shows "**DEL ALL**", press **DEL** key again to delete all the files.

To cancel delete function, just wait for LCD to stop flashing.

Remote Control

Battery installation:

To open up the battery cover (on the back side of the remote control) press down the cap and slide it from the left to the right, then pull it out. Place a new battery (battery type: CR2025 3V, positive upward).

Insert back into remote.

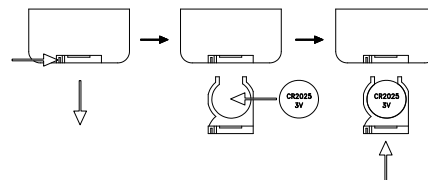

Functions

Identical to main unit with the addition of these two functions:

RAN: Press to play the tracks in a random order.
Press again to cancel.

MUTE: Press to mute, press again to return to normal playing.